



NOBODY MAKES MORE. NOBODY MAKES THEM BETTER.

Pair a strategic selection of attachments with your Bobcat® loader for a job-matched combination that saves time, reduces labor and generates income. Bobcat attachments are backed by Bobcat dealers – your source for quality parts, service and support.

MATCHED TO YOUR MACHINE

Built to match the specifications of your Bobcat machine, our attachments and implements are fully tested and ready to work with your machine. Many attachments can be used on multiple carriers to further enhance your versatility.

SUPERIOR DESIGN

Using Finite Elemental Analysis, Bobcat engineering teams ensure that your attachment delivers maximum performance when paired with Bobcat machines. Bobcat tests and enhances high-stress areas to improve durability.

EASY TO OPERATE

Bobcat attachment controls are always easy and intuitive. Most machines don't even require you to remove your hands from the controls during attachment operation. Smart electronics protect your machine and attachment from damage by locking out high flow when necessary, and make you more efficient by activating high flow automatically.

BACKED BY A ONE-YEAR WARRANTY

For even greater peace of mind, Bobcat gives you a one-year materials-and-workmanship warranty on our serial-numbered attachments.

BUILT TOUGHER WITH STATE-OF-THE-ART MANUFACTURING

Bobcat builds tens of thousands of attachments. Proven manufacturing processes are constantly refined to deliver better, more accurate weld penetration, improved durability and higher-quality components.

CHECK OUT ALL THE DIFFERENT BOBCAT ATTACHMENTS:
Bobcat.com/Attachments

Bobcat attachments are engineered and manufactured to fit Bobcat loaders for optimum job performance, dependability and durability. That's **The Bobcat Attachment Advantage!**

*Attachments subject to change.
*Certain specification(s) are based on engineering calculations and are not actual measurements. Specification(s) are provided for comparison purposes only and are subject to change without notice. Specification(s) for your individual Bobcat equipment will vary based on normal variations in design, manufacturing, operating conditions, and other factors.
Bobcat®, the Bobcat logo and the colors of the Bobcat machine are registered trademarks of Bobcat Company in the United States and various other countries.
©2016 Bobcat Company. All rights reserved.



Visit Bobcat.com/AnyJob for more information

B-1595 (06/16)



Bobcat®

Bobcat Company • P.O. Box 6000 • West Fargo, ND 58078

Printed in U.S.A.

Kn-10M-0616-49163-F



Loader Attachments



One Tough Animal®

ANGLE BROOM



Sweep a clean path economically.

Put your Bobcat loader to work and clean up almost everything in sight with the hydraulically driven angle broom attachment. Use it to sweep driveways, sidewalks, parking lots, loading docks, warehouses and more. Hydraulic angle broom allows operator to change angle with fingertip controls. Excellent tool for clearing light snowfalls.

BACKHOE



Turn your Bobcat loader into a powerful excavator with a full line of backhoe models.

Here's a part-time attachment that can handle full-time excavation jobs. Maximum digging depths range from 6 to 11 feet. Rear stabilizers are available for certain loader models. Operator training course also available.

BOX BLADE



Makes flatwork and grading easy and accurate.

Available in two heavy-duty models: with and without laser control. The box blade without laser is designed for rough grading and landscaping. The laser model has a grade accuracy of ± 0.25 inches and is designed for the precise grading required for most flatwork applications. Both models have a grading width of 84 inches.

BRUSH SAW



Cut brush down to size.

With its 28-inch, high-tensile steel blade, the brush saw is the quick, convenient way to remove unwanted brush. It's ideal for cutting firebreaks, clearing pastures and grasslands, and clearing road and utility line right-of-ways.

COMBINATION BUCKET



Perform a wide variety of jobs with one attachment.

The versatile Bobcat combination bucket is ideal for dozing, grappling, leveling, digging, loading and dumping. It's built with heavy-duty, replaceable cutting edges and hydraulic cylinders for long life on construction, demolition, landscaping and municipal jobs.

DIGGER



Dig it – coming or going!

The Bobcat digger not only digs in both forward and reverse, it also has an astonishing number of uses. It transplants small trees and shrubs, removes rocks and stumps, and carries and plants balled and burlapped trees. Put this versatile shovel attachment to work on a variety of jobs and watch it pay for itself with cost-effective efficiency.

DUMPING HOPPER



The handy, heavy-duty dumping hopper mounts as easily as a bucket on your Bobcat loader.

Drive it wherever needed to receive or dump material. Load it with a loader, compact excavator or by hand. It can be parked, detached from the loader, filled, then reattached to the loader and driven to the dumpsite. You can also use it to transport materials to hard-to-reach places.

AUTOMATIC GRADING ACCESSORIES

3D GRADING SYSTEM



Use digital designs and 3D machine control to quickly and accurately sculpt the land.

The 3D system works off elevation coordinates on the jobsite to grade valleys, ditches and contours. It can also display live point data, machine diagnostics and jobsite progress to an office computer.

AUGER (DIRECT DRIVE)



Dig 6- to 42-inch holes with speed and plumb-line accuracy.

The heavy-duty hydraulic auger bites in with high torque power. Because of its unique knuckle-joint design, the auger will hang plumb even on uneven terrain. Five models to choose from.

BALE FORK



Stabilizes the load and prevents bale rotation when handling round, uneven or square bales.

The two small-diameter tines are also effective in transporting large round or square bales and provide improved penetration in densely compacted material.

BREAKER



Break up concrete quickly and easily.

Choose from six models of this hard-hitting hydraulic breaker designed and built specifically for Bobcat loaders. X-Change™ mounting system allows quick change from skid-steer or track loader mount to excavator mount. Choose from a variety of tools including multiple points, chisels and tamping pads.

BUCKETS



When it comes to moving material, you can't beat a Bobcat bucket.

Choose from the widest variety in the industry, including general purpose buckets, dirt buckets, construction/industrial buckets, heavy-duty construction/industrial buckets, low-profile buckets, fertilizer/grain buckets and snow/light material buckets for loaders. Bolt-on teeth and cutting edges available for most models.

CONCRETE MIXER



Mixes, transports and dumps concrete faster than a traditional stand-alone mixer.

Compact size makes it perfect for sidewalks, driveways and finish work, plus footings and floors in small buildings. Mixer drum is made of $\frac{3}{16}$ -inch steel, with mixing fins of $\frac{1}{4}$ -inch reinforced steel for long life and durability. Drum rotates in either direction.

DOZER BLADE



The dozer blade turns your loader into a mini-crawler.

The dozer blade features a six-way adjustable blade with electric-over-hydraulic controls for on-the-fly adjustments and a reversible three-piece cutting edge.

FLAIL CUTTER



Clear brush and small trees up to 3 inches in diameter.

The ideal attachment for use on lakefront property, construction sites, power line and road right-of-ways, trails and other areas needing brush and thick grass removal. Floating linkage lets the unit follow the contours of the land for effective cutting. Flail cutter works on machines with 17-37 gallons per minute.

LASER GRADING



Control the grader or box blade automatically to save time, labor and materials.

If you're below grade, the extra concrete it takes to finish the job leaves thousands on the table. A Bobcat loader and a box blade or grader attachment equipped with laser control does the work of an entire survey crew, achieving better than ± 0.25 -inch accuracy.

AUGER (PLANETARY)



Dig deep holes with the efficiency and power of a planetary drive.

The planetary auger expands the Bobcat auger lineup to deliver more torque, increased dig depth, quick and easy hook-up and more. This auger is well-suited for digging in hardpan, shale, frozen ground, asphalt and rocky soil. The planetary augers also offer enough torque for screwing in anchors and screw pylons.

BORING UNIT



The easy way to install underground cables and flexible pipe.

Use the boring unit to install utilities under driveways, sidewalks and other obstructions with little or no damage to existing structures. Applications include placing electrical, telephone and television cables, and flexible water pipes for sprinkler systems.

BRUSHCAT ROTARY CUTTER



Clear brush and undergrowth as you've never done before.

The powerful cutting and mulching action of the dual-blade Brushcat™ rotary cutter clears a wide path as it cuts 3-inch diameter branches and saplings as well as the thickest grass and brush.

CHIPPER



Grind branches and tree limbs. Reduce branch volume 10 to 1.

Unlike pull-type models, the chipper can easily be placed in backyards and remote areas with the maneuverability of a Bobcat loader. Standard and high-flow chippers available.

CONCRETE PUMP



Places concrete in hard-to-reach areas.

With a standard hydraulic flow loader, the Bobcat concrete pump can place concrete up to 15 cubic yards per hour, or as much as 30 cubic yards per hour with a high-flow loader. It pumps as far as 250 feet horizontally and up to two stories vertically.

DROP HAMMER



Make short work of flatwork demolition.

Because the operator keeps the loader constantly moving – pausing momentarily to let the hammer drop to demolish the surface – large amounts of flatwork can be broken faster than with traditional hydraulic or pneumatic breakers. Up to 20 blows per minute.

FORESTRY CUTTER



Remove unwanted trees and provide organic material for the ones you keep.

Use the forestry cutter with the forestry applications kit to cut down trees or grind them into mulch from top to bottom. Simply lower the forestry cutter onto the tree, and its fast-cutting teeth can rip it to shreds, or tear it to pieces by repeatedly hitting it from the side.

SONIC AND SLOPE TRACER



Take pinpoint accuracy to jobsites where lasers can't be used.

Save on labor and materials to make more profit. The sonic tracer/slope sensor kit automatically creates accurate cross-slopes or precisely grades when laser receivers and transmitters are limited by jobsite obstacles, providing ± 0.25 -inch accuracy.

GRADER



Turn your Bobcat loader into an accurate grading machine.

Features an eight-way hydraulically controlled moldboard, operated with switches mounted on the loader's steering levers for easy control. For even more precise control on flatwork jobs, a laser control package is available that provides automatic control of the blade with ± 0.25 -inch accuracy. Available with 7-, 8-, or 9-foot moldboard.

GRAPPLE, ROOT



Clear your worksite of roots, rocks and debris.

Great for land clearing, landscaping, demolition, construction, rental or buildings and grounds maintenance. Heavy-duty design improves wear life in tough applications. Curved skeletal teeth allow dirt to fall between teeth, leaving dirt on-site.

MOWER



Mow down the rough stuff.

The mower is recommended for applications such as road ditch right-of-ways, golf course roughs and large acreage mowing. It is especially appealing to golf courses, landscape contractors, nurseries, hobby farms, municipalities and large-lot rural homeowners. Available in rear-discharge, side-discharge or mulching configurations.

REAR STABILIZERS



A set of frame-mounted, quick-attach rear stabilizers provides increased tree spade and backhoe performance.

Stabilizers help transfer the weight of the loader to the attachment to optimize digging performance. Grouser bars also help prevent the loader from being pulled toward the work. Street pads available.

SCRAPER



Cleans packed-on mud, snow and ice.

The Bobcat scraper is the perfect tool to remove stubborn, packed-on materials such as mud, snow and ice from driveways, sidewalks, parking lots and bike paths. It can even be used to aid in floor tile and carpet removal.

SNOW BLADE



Push snow aside before it's compacted.

Here's the ideal attachment for cleaning sidewalks, driveways, parking lots, alleys, service stations and warehouse lots. An optional end-wing kit turns some models into snow pushers. Trip moldboard or trip edge available. Standard snow blades feature a trip moldboard, and heavy-duty snow blades feature a trip edge.

SNOW PUSHER



Clear snow quickly on even or uneven surfaces.

The free-floating blade permits efficient snow removal on uneven surfaces; protects surfaces such as paving stones, decorative concrete and sloped sidewalks; and beats the competition for durability and smooth operation.

SPREADER



Spread it fast and easy!

Choose from electric or hydraulic drive to spread salt and sand for winter maintenance of parking lots, sidewalks, driveways and alleys. Electric-drive model can also spread grass seed and fertilizer. Both models have variable spreading patterns.

GRAPPLE, FARM FORK/UTILITY



Great on the farm or ranch.

The Bobcat utility grapple is ideal for handling bundled material, loose straw and manure. Use the fork separately or with a grapple. Grapple also fits many Bobcat buckets.

LANDPLANE



Remove large clods and rocks as you level and grade, going forward or backward.

The landplane breaks up hard ground and sorts unwanted debris from the soil. It can also be used like a bucket to transport material on-site.

PALLET FORK



Move bulky, bagged or palletized material with ease.

The pallet fork attachment is ideal for all kinds of farm chores, including fertilizer handling, as well as applications in industrial plants, landscaping and construction sites where bales, bags and pallets have to be moved. Two models with hydraulically adjustable forks are also available.

ROCK BUCKET



Remove unwanted rocks from fields and landscapes.

Skeletal design keeps the rocks and lets the dirt fall through. Separate unwanted objects, rocks and debris while leaving finer material behind with the rock bucket attachment.

SEEDER



Accurate seed placement and adjustable metering.

Unlike broadcast seeders, the Bobcat seeder places the seed with the proper spacing and at precisely the right depth for better germination. With a production rate of more than 2 acres per hour, the seeder is efficient and cost-effective. Seeder mounts to 3-point hitch or loader.

SNOW V-BLADE



Scoop, clear, pile and push snow.

Bobcat snow V-blades have far more versatility than a standard snow blade or snow bucket. With five different blade configurations, the hydraulically operated V-blades gives operators a choice of ways to move snow fast. Blades available from 5 to 9 feet.

SOD LAYER



Carry and lay a roll of sod up to 4 feet wide.

Lay sod in a fraction of the time with a fraction of the crew compared to laying by hand. Exclusive lock and pin system automatically prevents unrolling during transport.

STEEL TRACKS



You'll get better performance in sand, snow and mud.

Float over soft, sandy or muddy ground and get better traction on slippery surfaces with over-the-tire Bobcat steel tracks.

GRAPPLE, INDUSTRIAL



Grapple bucket or grapple fork.

They allow easy handling of a variety of hard-to-manage materials in the industrial setting or construction site. They're built tough for reliability and long life!

LANDSCAPE RAKE



Soil preparation for seeding, sodding, smoothing and finishing.

Break up lumpy soil and pick up rocks as small as 0.5 inches. Use the landscape rake for ground preparation for seeding, sodding and lawn leveling. One-pass coverage.

PLANER



Make your Bobcat loader an efficient, cost-effective planing machine.

Cut and mill concrete and asphalt with the controlled removal process of the planer attachment. Standard-flow planer provides excellent performance on standard-flow machines, allowing a lower initial investment for those that only need to use a planer periodically. High-flow planers utilize the increased hydraulic horsepower available for high production needs.

SCARIFIER



Prepare hard-packed soil for digging or landscaping.

Use a Bobcat loader's power to rip the toughest hardpan. Adjustable skid shoes and teeth provide multiple-depth ripping.

SILT FENCE INSTALLER



Erosion control made simple.

Meet erosion control regulations and avoid costly governmental fines. The silt fence installer is the fastest, easiest and most economical way to install silt fence for residential, commercial, industrial or highway projects. Mounting frame options allow quick change from loader to tractor.

SNOWBLOWER



The perfect winter cleanup tool.

Blow snow off driveways and sidewalks or in those tight quarters where only a Bobcat loader can fit. Rotational spout directs snow where you want it to go. High-flow models are available for loaders with high-flow option package.

SOIL CONDITIONER



A versatile landscaping tool.

Use it to separate rocks and debris, grade, level, fill – even tear out old sod. Produces perfect beds for seeding or sodding. Pulverizes dirt clods while keeping rocks and debris ahead of roller action. End plates can be attached to simulate box blade.

STUMP GRINDER



Carbide-tipped teeth and fingertip controls make tree stumps disappear fast.

Models SG60 and SGX60 have a 58-inch reach and 80-degree arc, allowing you to cut large stumps up to 45 inches in diameter without repositioning. The work group is mounted at an angle of 90 degrees for excellent visibility. The SG30 has a maximum cutting height of 11 inches with a 90-degree arc.

SWEeper



Sweep in forward or reverse.

Ideal for construction, industrial or municipal jobs. Its reversible cutting edge helps cut caked-on mud, while the sweeper's poly bristles deposit dirt and debris in the container, which can be dumped when full. Optional gutter brush (certain models) gets the dirt from curbs, along buildings and drainage depressions.

TREE SPADE



Dig and load trees in minutes!

The tree spade attachment turns your Bobcat loader into a transplanting unit. A tree can be dug, transported or loaded without the operator having to leave the loader. It not only digs trees, but it also loads them onto a truck or trailer in minutes – and one person is all you need on the job!

VIBRATORY PLOW



Place wire or pipe with minimal ground disturbance.

The vibratory plow pulls up to 1.5-inch diameter flexible pipe, cable or wire 6 to 18 inches below ground, while keeping ground disturbance to a minimum. Applications include new sprinkler systems as well as placing phone, TV and electrical wire.

WHEEL SAW



Powerful cutting in asphalt and concrete.

Powered by a high-flow Bobcat loader, wheel saw models WS18 and WS24 cut through asphalt, concrete, frozen ground and wire mesh. Wheel saws provide a more precise cut than air or hydraulic hammers. Perfect for road repair and laying water, gas, electric and fiber-optic cables.

EXCLUSIVE BOB-TACH SYSTEM

Featuring the exclusive Bob-Tach system for fast, secure attachment changes.

As quick as a snap, you can replace a bucket with a pallet fork, landscape rake, backhoe, auger, grapple and more, thanks to the exclusive Bob-Tach® mounting system. The heavy-duty Bob-Tach system features spring-loaded, wear-compensating wedges for a secure fit time after time.

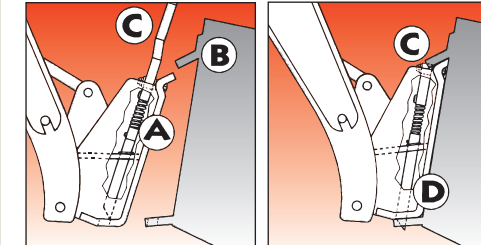

Bob-Tach frame (A) moves into attachment flange (B); handle (C) pushes down easily, pressing wedge (D) through frame and attachment hole for solid connection.

Power Bob-Tach™ mounting system also available.

ATTACHMENT CONTROL KIT

Control additional functions on selected attachments with switches on the steering levers.

Attachment Control Device (ACD)

Electronically controlled attachments are equipped with an attachment control device (ACD). The ACD tells your Bobcat compact loader which attachment is connected and identifies its performance requirements.



TILLER



A great landscaping attachment.

Ideal for breaking up clumps and mixing compost or other materials into existing soil. Features bi-directional rotation, a 6-inch maximum depth, offset mounting, and replaceable, hardened tines.

TRENCH COMPACTOR



Compress soil after power or water lines have been installed in a yard, golf course or other shallow trench application.

The trench compactor features replaceable pads and works on a Bobcat loader with the lift arms in the "float" position while driving forward over the trench.

VIBRATORY ROLLER



Compaction tool for construction and flatwork.

The Bobcat vibratory roller features either a smooth or padded drum. The roller is ideal for flatwork, trenching and asphalt patchwork contractors.

TILT-TATCH DEVICE



Makes Bobcat buckets, pallet forks and other attachments even more versatile.

The Tilt-Tatch™ mounted hydraulic tool can rotate an attachment right and left 15 degrees from center, allowing you to position attachments independently of the loader when working on a grade. Or use it to dig a trench with the corner of the bucket.

TRENCHER



Versatile trenching ability.

Use a Bobcat trencher for a variety of jobs. Adjustable digging depth capability. Manual or hydraulic side-shift gets close to walls. Trench cleaner is standard equipment. Models LT405 and LT414 are designed specifically to take advantage of high-flow hydraulic capabilities of certain Bobcat loaders. Six models.

WATER KIT



Spray the dust away.

Keep the dust under control when using Bobcat attachments such as the angle broom, sweeper, planer and vibratory roller.

